



**SILENT
KNIGHT**

by Honeywell

Model SD500-ARM Addressable Relay Module

Place relay applications anywhere on the IntelliKnight loop with the SD500-ARM Addressable Relay Module.

The SD500-ARM is an addressable device that adds great flexibility to the IntelliKnight system. Providing two Form C contacts rated at 2.0 amps @ 30 VDC or .6 amp @ 120 VAC. The SD500-ARM allows you to control a wide variety of normally open and normally closed applications, including elevator recall, door closing, fan operation, and auxiliary notification. And, because the relay module is addressable, these applications can be located at any point in the signaling line circuit.

Like other IntelliKnight SLC devices, the SD500-ARM is compact for adaptability and pleasing aesthetics. Combine this with the features you've come to expect from Silent Knight fire protection devices—easy installation and stable operation—and it adds up to a flexible solution for all your fire protection needs.

Model SD500-ARM Addressable Relay Module

The SD500-ARM provides two Form C contacts rated at 2A @ 30 VDC or .6A @ 120 VAC. These contacts can be used for virtually any normally open or normally closed application.

Operation

Each relay module is programmed with a unique SLC loop address. When an event that controls the relay module occurs, the relay is triggered by the IntelliKnight panel.

Features

- Two sets of Form C contacts.
- Contacts are rated at 2A @ 30 VDC or .6A @ 120 VAC.
- Up to 127 relays can be used on each SLC loop.
- Relay programming is completely flexible—can be mapped to zone conditions.
- Polling LED visible through cover plate.

Specifications

Contact Rating:	Form C
	2A @ 30 VDC
	.6A @ 120 VAC
Standby Current:	.55 mA
Alarm Current:	.55 mA
Ambient Temperature:	32°F to 120°F (0°C to 49°C)
Mounting:	4-square electrical box

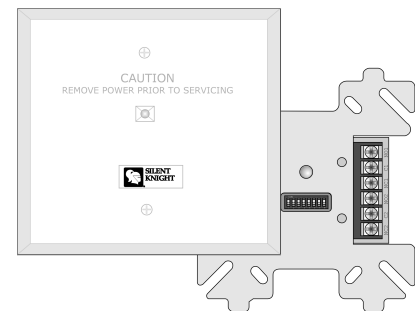

Model SD500-ARM

Listings

- UL listed, complies with NFPA 72.
- CSFM approved
- MEA Approved, 429-92-E, Vol. 9
- FM approved

Compatible Control Panels

- 5820XL
- 5820XL-EVS
- 5808
- 5700

Model SD500-ARM Addressable Relay Module

Engineering Specifications

The contractor shall furnish and install where indicated on the plans, addressable relay modules, Silent Knight SD500-ARM. The modules shall be UL listed compatible with Silent Knight's Intelliknight FACPs.

The relay module must provide two Form C dry contacts rated at 2.0 amps at 30 VDC or .6 amp at 120 VAC.

The relay module must be suitable for mounting in a standard 4-square electrical box and must include a plastic cover plate. The relay module board must provide an LED that is visible from the outside of the cover plate.

The relay must be fully programmable for such applications as are required by the installation.

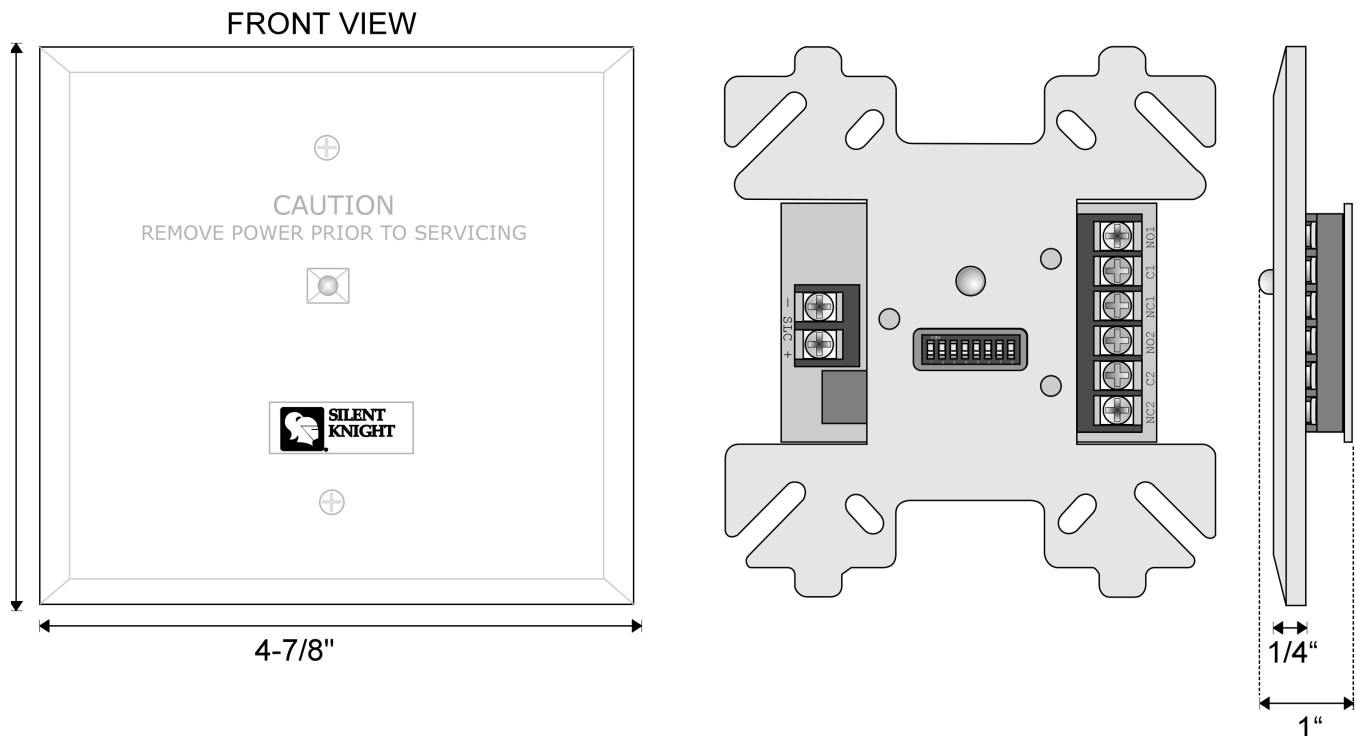

Model SD500-ARM Addressable Relay Module Dimensions



This document is not intended to be used for installation purposes. We try to keep our product information up-to-date and accurate. We cannot cover all specific applications or anticipate all requirements. All specifications are subject to change without notice. For more information, contact Silent Knight 12 Clintonville Road, Northford, CT 06472-1610. Phone: (800) 328-0103, Fax: (203) 484-7118. For Technical Support, Please Call 800-446-6444. www.silentknight.com

MADE IN AMERICA

FORM# 350218 Rev. E

© 2013 Honeywell International Inc.